

# TARGA 58 GTB

2021 Model Year  
Standard Specification



Main Deck



Main Deck - Beach Club

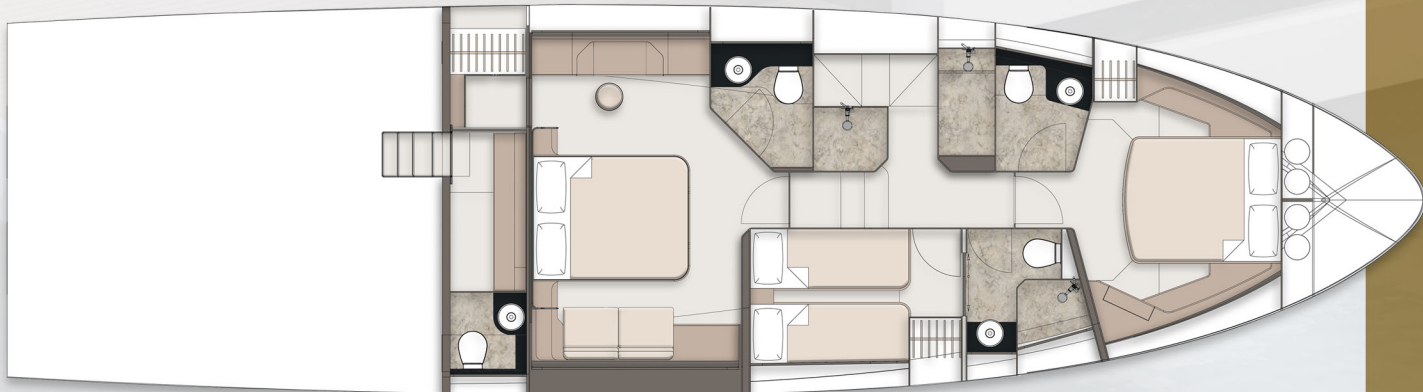

Lower deck

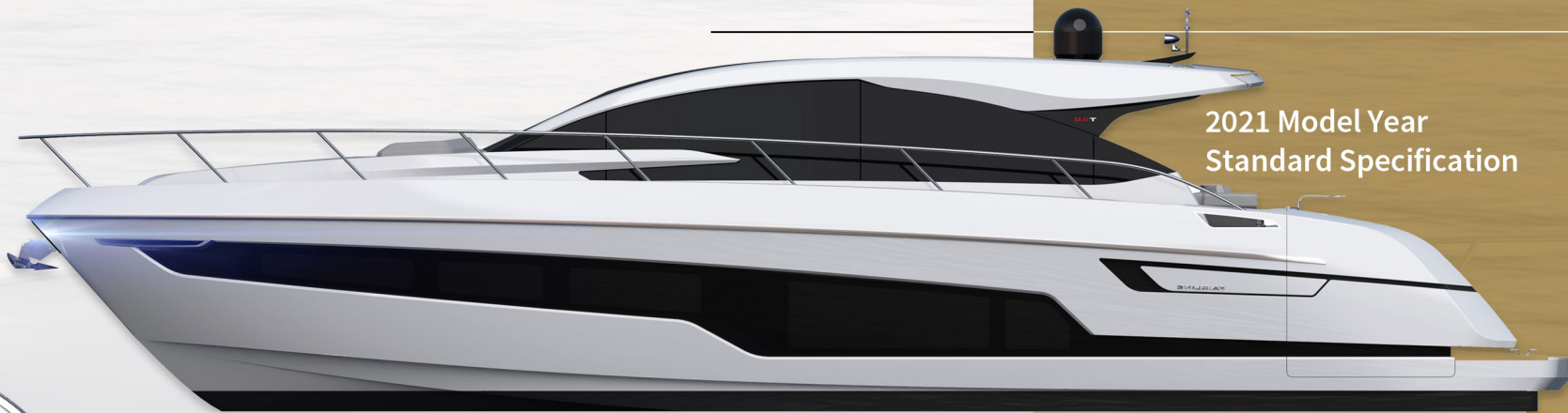

## Principal Dimensions

Length overall (incl. pulpit):	60' (18.28m)
Length overall (excl. pulpit):	58'8" (17.91m)
Beam (incl. gunwale):	16'3" (4.97m)
Draught:	4'9" (1.5m) unloaded
Berths:	6 - 7
Height above waterline:	13'8" (4.21)
Transport height:	16'4" (5.0m)
Dry weight (approx.):	26.62 imp. tons / 29.82 US tons (27,051kg)
Fuel capacity:	484 gallons / 581 US gallons (2,200 litres)
Water capacity: (incl. calorifier)	132 gallons / 158 US gallons (600 litres)

## Engines and Performance

2 x Volvo Penta D13-900	2 x Volvo Penta D13-1000
Max. power: 1800 hp	Max. power: 2000 hp
Drive: Shaft	Drive: Shaft
Fuel: Diesel	Fuel: Diesel
Max. Speed: 29 knots (est.)	Max. Speed: 31 knots (est.)
2 x MAN V8 1200	
Max. power: 2400 hp	
Drive: Shaft	
Fuel: Diesel	
Max. Speed: 33 knots (est.)	

Type approval:	CE Category B
Capacity:	16 people



# TARGA 58 GTB

## Deck:

- Anchor chain locker
- Anchor winch controls
- Anchor winch (electric)
- Calibrated anchor chain (10mm, 60m length)
- Carbon fibre ensign staff
- Fender x8
- Foredeck drinks holders
- Foredeck seating & fixed sunbeds
- Foredeck storage lockers
- Fuel fillers
- Full set of IMCO navigation lights
- Handrail
- Hot & cold water transom shower
- Moulded non-slip deck surface
- Remote control searchlight
- Riding light
- Self-stowing stainless steel Delta® anchor
- Stainless steel aft fairleads
- Stainless steel bow fairleads
- Stainless steel bow, cockpit, stern & twin spring cleats
- Stainless steel rubbing strake with rubber inserts
- Stainless steel pulpit
- Swim ladder to bathing platform
- Teak laid bathing platform
- Twin horns
- Water filler
- Windscreen washers
- Windscreen wipers

## Helm Position:

- USB port
- Adjustable/tilt steering wheel
- Bilge pump switches with integral operating warning lights & audible alarms
- Black mesh windscreen & forward side window covers
- Bow thruster controls
- Controls for engine bay fire extinguisher system
- Drinks holders
- Electronic single-lever throttle & gear controls for port & starboard engines
- Glass Bridge incorporating full engine instrumentation; tachometers, fuel gauges, temperature gauges, audible alarms, rudder position indicator f-Drive (Fairline multi-function glass bridge)
- Garmin 16' digital multi-function instrument system with colour display (1 screen as standard, second or third screens optional)
- Garmin autopilot
- Garmin VHF marine radio
- Garmin tri-data display
- High speed magnetic compass
- Power steering
- Powered glazed sunroof with internal blind

- Red night-light illumination to helm
- Remote anchor winch controls
- Searchlight controls
- Switchgear
- Trim tab controls
- Twin helm seats

## Electrical Systems:

- 230 - 240V 50Hz
- All 240V, 24V & 12V circuits (where applicable) protected by circuit breakers with main electrical load control panel
- Heavy duty circuit breakers
- Isolating switches to all batteries
- Onan® 11kW generator

### 12 Volt

- Voltage dropper from domestic batteries

### 24 Volt

- 2 x heavy duty battery for exclusive port engine starting
- 2 x heavy duty battery for exclusive starboard engine starting
- Batteries - 4 x heavy duty batteries wired in parallel supplying domestic services & port engine starting
- Circuit breaker for anchor winch
- Emergency battery coupling system permits each engine to start from opposite battery bank
- Inverter
- Isolation summation transformer
- 240 Volt**
- Polarity check & earth leakage protection system
- Power points throughout the boat fed from shore power or generator
- Regulated 75amp charger for domestic batteries
- Shore power supply line

## Cockpit:

- 12V heavy duty weatherproof socket
- Access to lazarette or crew cabin
- Access to side deck
- Beach club area to stern
- Boat hook
- Cockpit bar unit (fridge & sink)
- Cockpit cover (white)
- Deck level lighting
- Deck wash outlet
- Domestic master switch to manual bilge locker
- Drinks holders
- Engine bay access hatch with stainless steel gas struts
- Fairline hi-low Beach Club bathing platform
- Fender stowage
- Fusion audio system with wireless connectivity (4 speakers)
- Life raft stowage
- Manual bilge pump
- Mooring warps
- Mooring warp stowage

- Seating
- Single level floor from cockpit to saloon
- Storage lockers
- Teak laid floor throughout Beach Club & self-draining cockpit
- Teak table with drinks holders & integrated handrail
- Twin transom gates
- Wet stowage locker
- USB socket

## Interior Décor:

Choice of interior finishes selected by the Fairline Yachts Design Studio

## Hullform & Construction:

- Antifouling protection to hull
- Bow thruster
- Deep 'V' hull
- Design, layout & detailing by AM Yacht Design and the Fairline Yachts Design Studio
- Naval architecture by J&J
- Feature windows with opening portholes
- Full length moulded spray deflectors
- Hull colour – white
- Hull/deck joint bolted & bonded
- Integrally moulded engine bearers
- Resin infused cored hull & liner with hand-laid deck & components

## Dinette:

- Sofa with stowage
- Fixed height table
- 2 x stools with leather retaining straps

## Saloon:

- LCD TV
- Fusion audio unit with wireless connectivity
- Electric hardtop with overhead glazing
- Fixed height feature coffee table
- 6 x Tumblers
- Overhead lighting
- Wood flooring
- Sliding patio door to cockpit with swing up (manual) functionality
- Feature inlay rug
- Venetian blinds

## Galley:

- Avonite® work surface
- Chopping board to sink infill

- Crockery stowage
- Melamine Dinner service 24-piece, 6 place settings
- Fire extinguisher
- First aid kit
- Fridge/freezer full height
- Induction hob
- Integrated waste bin
- Microwave combi oven
- Overhead lighting
- Wood flooring
- Sink with hot and cold mixer tap
- Stowage cupboard and drawers
- Extractor

## Lobby:

- Access to electrical control panel
- Handrail
- Lighting to stair risers
- Space for optional domestic appliance

## Master Cabin:

- Aluminium venetian blinds
- King bed with storage drawers
- Feature windows with opening portholes
- Mirror feature to bulkhead
- Overhead feature lighting
- Reading lights
- Wrap around headboard with storage shelves
- Sofa with stowage
- Vanity unit with stool
- Fusion head unit 2x speakers
- TV
- Wardrobe

## Master Cabin En Suite:

- Automatic shower tray pump-out system
- Electric silent-flush freshwater toilet
- Extractor fan
- Full set of bathroom fittings
- Full standing-height shower
- Hand basin with hot & cold water
- Large hull window with single opening port hole
- Mirror
- Wood floor

## Forward Cabin:

- Aluminium venetian blinds
- Vanity unit
- Double bed with single large storage drawers
- Escape hatch to foredeck with blackout blind
- Feature windows with opening porthole
- Reading lights
- Wardrobe



# TARGA 58 GTB

## Forward Cabin En Suite:

- Aluminium venetian blinds
- Automatic shower tray pump-out system
- Electric silent-flush freshwater toilet
- Extractor fan
- Solid surface vanity unit locker & basin with hot & cold pressurised water
- Full set of bathroom fittings
- Full standing-height shower with integral shower tray & adaptable shower head
- Hand basin with hot & cold water
- Mirror
- Mirrored lockers
- Overhead lighting
- Wood floor

## Starboard Guest Cabin:

- Aluminium venetian blinds
- Bedside table
- Feature windows with single opening porthole
- Full length berths x 2
- Wardrobe
- Mirror
- Overhead lighting
- Reading lights

## Starboard Cabin En Suite / Day Head:

- Aluminium venetian blinds
- Automatic shower tray pump-out system
- Electric silent-flush freshwater toilet
- Extractor fan
- Solid surface vanity unit locker & basin with hot & cold pressurised water
- Full set of bathroom fittings
- Full standing-height shower with integral shower tray & adaptable shower head
- Hand basin with hot & cold water
- Mirror
- Mirrored lockers
- Overhead lighting
- Wood floor

## Crew Cabin (optional):

- Access from cockpit
- Electric silent-flush freshwater toilet
- Feature window with blind

- Hanging locker
- Mirror
- Opening porthole
- Overhead lighting
- Power point
- Sink with hot & cold mixer tap
- Full length berth with foam mattress

## Engines & Sterngear:

- Automatic bilge pumps for forward bilge, engine bay & rudder bay with manual 'on' override
- Automatic engine room fire extinguisher system
- Dripless shaft seals
- Electric engine room fans
- Engine air intakes
- Engine room lights
- Engine room soundproofing
- Exhaust overheat warning system
- High capacity emergency manual bilge pump system
- Interceptor trim tabs
- Manganese bronze 'P' brackets
- Manganese bronze propellers contrarotating
- Seacocks on all inlets/outlets below waterline
- Stainless steel alloy shafts

## Fuel System:

- Emergency fuel shut-off valves
- High capacity water separators & fuel filters
- Individual fillers, vents & splash stops to port & starboard
- Twin fuel tanks with balance pipe

## Freshwater System:

- Automatic, pressurised supply
- Calorifier hot water system
- Water tank - 600 litre capacity

## Blackwater System:

- Holding tank (170 litres) with electric macerator pump-out

## Commissioning:

Commissioning, pre-delivery inspection & handover at Fairline Commissioning Centre, Ipswich, UK

## USA Specifications:

- Voltage - 2 x 110V (220V) 60Hz

Whilst every effort is made to keep all sales literature up to date, it should not be regarded as an infallible statement of current specifications & does not constitute an offer for the sale of any particular boat.

We continually seek to improve the specification & design of our boats, so alterations & upgrades to specifications take place continually.

Appointed dealers are not agents of Fairline Yachts Ltd & are not authorised to commit Fairline Yachts Ltd by any express or implied undertaking or representation.

Performance Figures: Power quoted in our literature for engines is crankshaft output.

Performance Estimates: Performance estimates are given in good faith but are in no way guaranteed for any particular model. Dirt on the bottom of the boat, damage to the propellers, engine tuning, external water & air temperatures & the weight of crew, fuel & water carried can all adversely affect performance.

For those & other reasons we can give no performance guarantees